

## When a Mobile Device Cannot Be Connected

Please check the following points if a mobile device, such as an iPhone or iPod touch, cannot be connected.

### 1. Check the indicator LED

Make sure that the MODE indicator LED is lit. The connection between the mobile device and GUN-TYPE is not complete when the LED is blinking. If the indicator LED is lit but you cannot connect via the application, restart the application or contact the application developer.

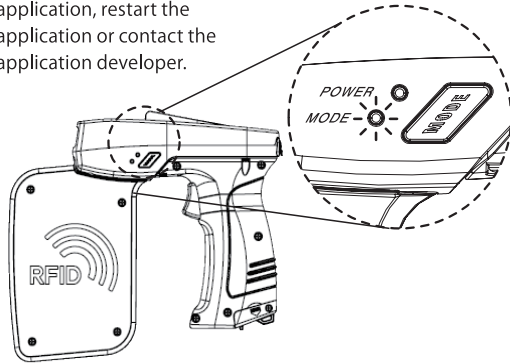

### 2. Check if the Header part is installed correctly

Check that the Header is correctly connected to the GUN-TYPE.

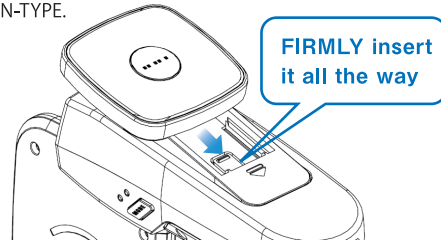

### 3. Reconnect the mobile device

To eliminate the possibility of a bad connection with the GUN-TYPE, please wipe each terminal with a clean, soft cloth and reconnect the mobile device.

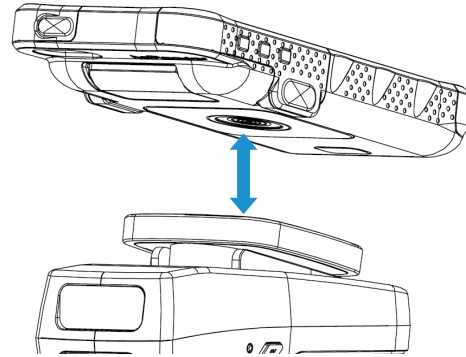

### 4. Restart the mobile device/GUN-TYPE

Restart the mobile device or the GUN-TYPE by turning the power OFF and then ON.

### How to Assemble R250G

<https://youtu.be/Psh-Yko9be4>

## If the GUN-TYPE is not functioning properly

In rare cases, the GUN-TYPE may become inoperable. Please reset the GUN-TYPE by pressing and holding the Reset button for 1 second or more with a thin rod-shaped object.

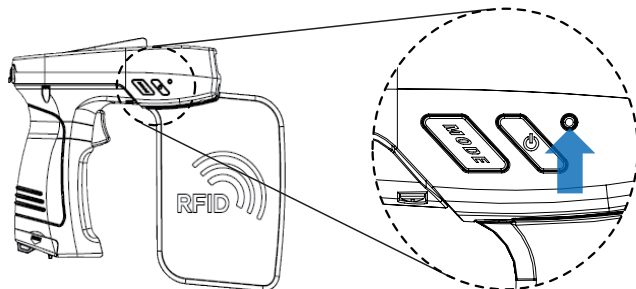

## ASR-R250G series

**AsReader**

User's Manual

**Asterisk**

Thank you for purchasing the Handheld GUN-TYPE AsReader ASR-R250G series.

This product is a handheld device that can read/write RFID tags and the ASR-R250G-2X series can read barcodes as well. This manual contains important safety instructions for using the AsReader ASR-R250G.

Please read the manual carefully and keep it as long as you have the device.

※ We may refer to the "AsReader ASR-R250G" as "the device" or "this device" in some sections of this manual.

### Inside the Box

The following items are contained in the box. Please first make sure you have all of these items. In the case that item (s) are missing, please contact the distributor from whom you purchased the device.

- AsReader .....1 pc
- micro USB cable .....1 pc
- User's Manual (this paper) .....1 pc

### Name of each part of the AsReader

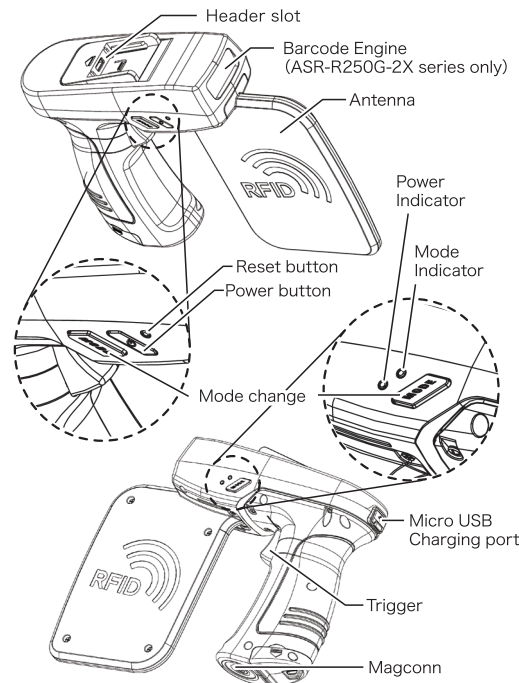

## Before use

This product has a variety of international models. Please confirm that the device is the correct model for your region. If you need a model for a different region, please contact the distributor from whom you purchased the device.

In order to use this product with an iPhone/iPod touch (iOS device), the following parts are required.

- AsRing+ (ASA-102R)
- Spacer (ASA-102R-SP)
- Header (ASA-R250-HD)
- AsReader Case for Dock/Sled (ASC-XX series)

With the above parts, an iOS device can be attached and used with the ASR-R250G.

For use with an Android device, please contact us or your distributor to confirm if we have an AsReader Case for your Android model. Although most OTG supported devices can be used, we do not guarantee that all Android models are compatible.

Please contact your distributor for more information.

## Safety Instructions

Please read the following instructions carefully to prevent injury, malfunction, fire, etc.

### Warning

Do not attempt to disassemble, modify or repair the device yourself. This will void warranty coverage and may also cause fire, electric shock, or malfunction.

This device operates under the UHF Band. It may affect the operation of some medical devices depending on the environment. Following the guidelines below may reduce these affects.

1. For users of this device:  
Keep at least a 22cm distance from implantable/implanted medical devices.
2. For users with implanted medical devices:  
Keep at least a 22cm distance from this device.
3. Use of this device may result in violation of local laws or regulations in some foreign countries.  
Please contact us before using the device overseas.

This product conforms to radio frequency laws. Modifying radio equipment is illegal and violators will be prosecuted. Before using the device, please contact us or your distributor to confirm the device meets local regulations.

Stop using the device if you notice any smoke or a burning smell coming from the device. Unless the device is fixed, it may cause fire or electric shock.

Do not drop, throw, or slam the device. Do not expose this device to fire, high temperatures or water. If you notice any damage to the device, stop using it. Use of a damaged device may cause fire or electric shock.

Do not attempt to recharge the battery near any liquids or when the device is wet. The parts may be damaged if short-circuits or electrical shorts occur. Do not touch the parts with wet hands or attempt to use this device in wet conditions. Avoid water around terminal parts. Do not use the device in a bathroom. Failure to follow the Safety Instructions may result in fire or electric shock.

Avoid leaving the device in a hot place as this may damage it.

The device's Magconn connector has a magnet which has a risk of causing deletion of data on magnetic stripe cards. Therefore, please keep any magnetic stripe cards, or related items, at least 100mm (4 inches) away from the device.

### Caution

Only use the AC Adaptor and Magconn connector specified by the manufacturer. Standard iPhone/iPod touch charger (5V2A) is strongly recommended for use with the Magconn cable. Using different chargers may result in failed charges.

Please refer to local regulations when you recycle this device.

If you notice any abnormalities, please discontinue use and contact your distributor immediately.

Interference from external radio waves or surrounding electronic equipment may cause the device to not function properly. Please use the device with caution in this type of environment.

### Laser Safety Precautions

#### **\*For ASR-R250G-2X series only**

This is a Class 2 Laser product. Do not look into the laser light or point it at anyone. Looking directly in to the laser may cause injury to the eyes. To prevent misuse, keep this device away from children or people without knowledge of the product.

If injury from the laser light is suspected, please consult a doctor immediately.

## About Power ON/OFF

When the power indicator is not lit up, press and hold the power button for more than 1 second and the device will turn on, with a beep sound.

While the power is ON, the mode indicator will be flashing blue. You can turn off the power by pressing and holding the power button for more than 1 second.

The device will go into sleep mode after 5 minutes of inactivity while the power is ON. The device will automatically power OFF after 30 minutes of inactivity. The automatic power OFF time can be changed in the settings.

Additionally, if a hardware problem is detected, the device may restart automatically. If the device restarts repeatedly, it may have malfunctioned, so please try using the "Reset" button. If this does not resolve it, please contact your distributor.

## How to charge

This product can be charged by microUSB or Magconn. Please use the included microUSB cable and Gender\* included with the AsRing+. (\*Gender is an adapter between Magconn and microUSB.)

Please fully charge the device before using it for the first time or when it has been unused for extended periods. The power indicator light is red when charging. When a mobile device is connected, both the AsReader and mobile device can be charged simultaneously. When the mobile device connected to the AsReader is fully charged, the power indicator will light green.

When charging both the AsReader and mobile device, we recommend using a 5V2A power adapter. The charging time of the device from empty to full is about 4 hours (with a 5V2A power adapter).

### Warning

Do not charge the device with a power adapter other than 5V, since this may cause a malfunction and is not covered by the warranty.

## About the Mode button

The mode button's functionality can be set by an application on the mobile device. It can be used for switching between RFID / barcode scanning for the ASR-R250G-2X series, switching views on an application, and many more functions.

The mode button for the ASR-R250G-2X series is set by default to switch between RFID / barcode scanning modes. With this default, pressing the mode button switches the device between RFID / barcode scanning modes with a beep sound.

## Description of Indicators

The LED indicators show the status of the device.

[Mode indicator]

Power on (blinking blue)

Connecting (solid blue)

Reading (blinking blue)

[Power indicator]

Charging (solid red)

Charging is complete (red light will turn off)

Charging error (blinking red)

## How to scan

Operation varies depending on the reading mode.

[RFID mode]

RFID tags are read while the trigger is pulled.

Since the number of tags being read depends on the device settings, e.g. Session, please make sure the settings are correct.

[Barcode mode]

Pull the trigger to read a barcode while the white light and red aiming-laser is visible.

A specific application is required to display the scanned data. Please contact your distributor or check our website for more information.

## How to Care for the Device

Please keep the device clean. If the device becomes dirty, wipe it with a soft, dry cloth.

Using solvents of high-volatility may cause color changes and performance problems.

## Changing the Battery

Battery exchanges are available at the user's cost. Battery exchanges by end-users are not allowed and voids the warranty.

Please contact your distributor for more information.

## Troubleshooting: If you think the device is broken

Please check the following before contacting your distributor:

## Cannot connect to Mobile Device

The mobile device may not recognize the AsReader due to problems with the connection or an app. Please check the following:

1. Please check that the Header is correctly attached. (Firmly push it in to its slot.)
2. Try removing/reattaching the mobile device to confirm that the devices are properly connected.
3. If the mode indicator is lit blue, this indicates a successful connection between the AsReader and mobile device. In this case, there is a high possibility that the problem is on the application side, so please contact the application development company.

## Cannot scan

If the device does not scan, please try the following:

1. Please confirm the device's battery is sufficiently charged.
2. If the application is not responding, please try restarting the application.
3. Please confirm the settings for RFID/barcode scanning are correct.

## Support Information

iOS ver.8.0 or later is supported (at the time of the printing of this manual). We will post information regarding new iOS versions that are supported onto our website. (As of May 1, 2017)

To find the latest firmware information for the devices and how to update them, please check the AsReader developer website.

<AsReader Website>  
<https://asreader.com>

<AsReader Website for Developers>  
[http://developer.asreader.jp/sdk/gun/index\\_en.html](http://developer.asreader.jp/sdk/gun/index_en.html)

- Warranty lasts 1 year from the date of purchase.
- Please keep documentation to prove the date of purchase, since it will be required for a warranted repair service. For repair services, please contact your distributor.
- Design and specifications are subject to change without notification.
- iPhone and iPod touch are trademarks of Apple Inc.

Asterisk, Inc.

Shin-Osaka Dainichi Building 201, 5-6-16  
Nishinakashima, Yodogawa-Ku, Osaka, 5320011, Japan  
TEL: 050-5536-1185 FAX: 06-6886-1114  
<https://asreader.com>